

CREATED: July 26, 2022
DEPARTMENT: RTiC

Using a Diskus

DRY POWDER INHALER

DISKUS

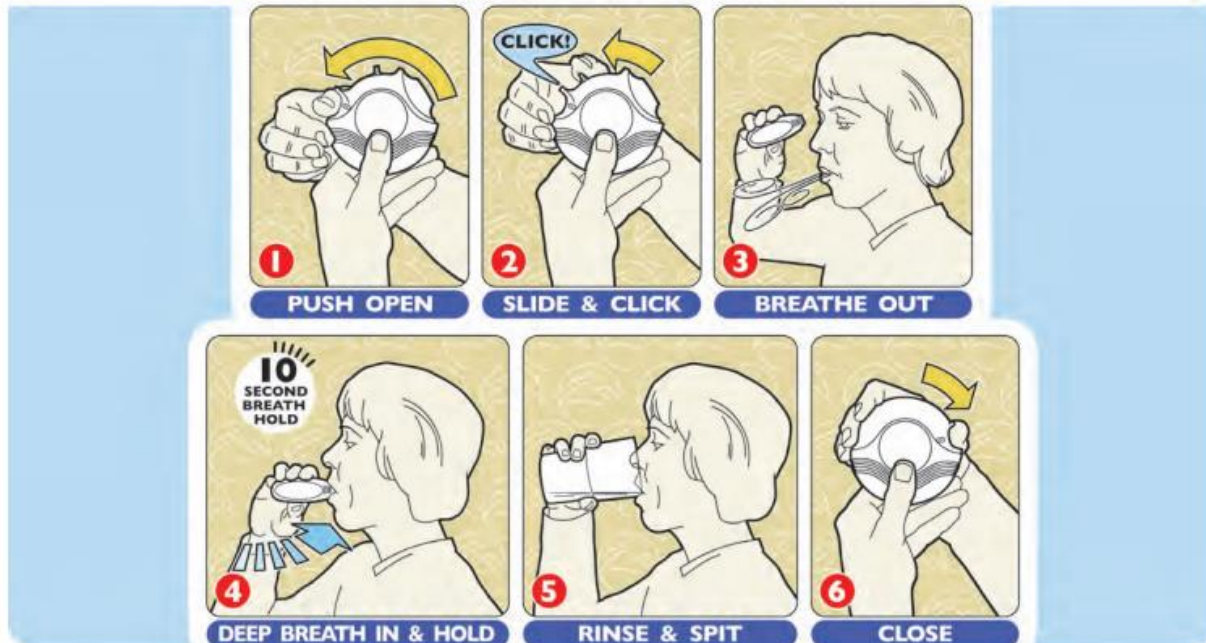

IMPORTANT INFORMATION

- Note:** Place mouthpiece between your teeth and close your lips.
- Empty?:** The window has numbers that count down the dose – "0" means it is empty. Throw it away.
- Expired?:** Check the expiry date on the back of the device.
- Reminders:** Keep the Diskus dry.
Do not breathe into the device.
Close after use.
- Cleaning:** Wipe mouthpiece with a dry tissue or cloth.

This material is designed for information purposes only. It should not be used in place of medical advice, instruction and/or treatment. If you have specific questions, please consult your doctor or appropriate healthcare professional.

Illustrations developed by the Community Pediatric Asthma Service, www.ucalgary.ca/icancontrolasthma

Instructions used with permission from Calgary COPD and Asthma Program-Alberta Health Services